

ADVANCED HEAT EXCHANGERS

PLATE & FRAME

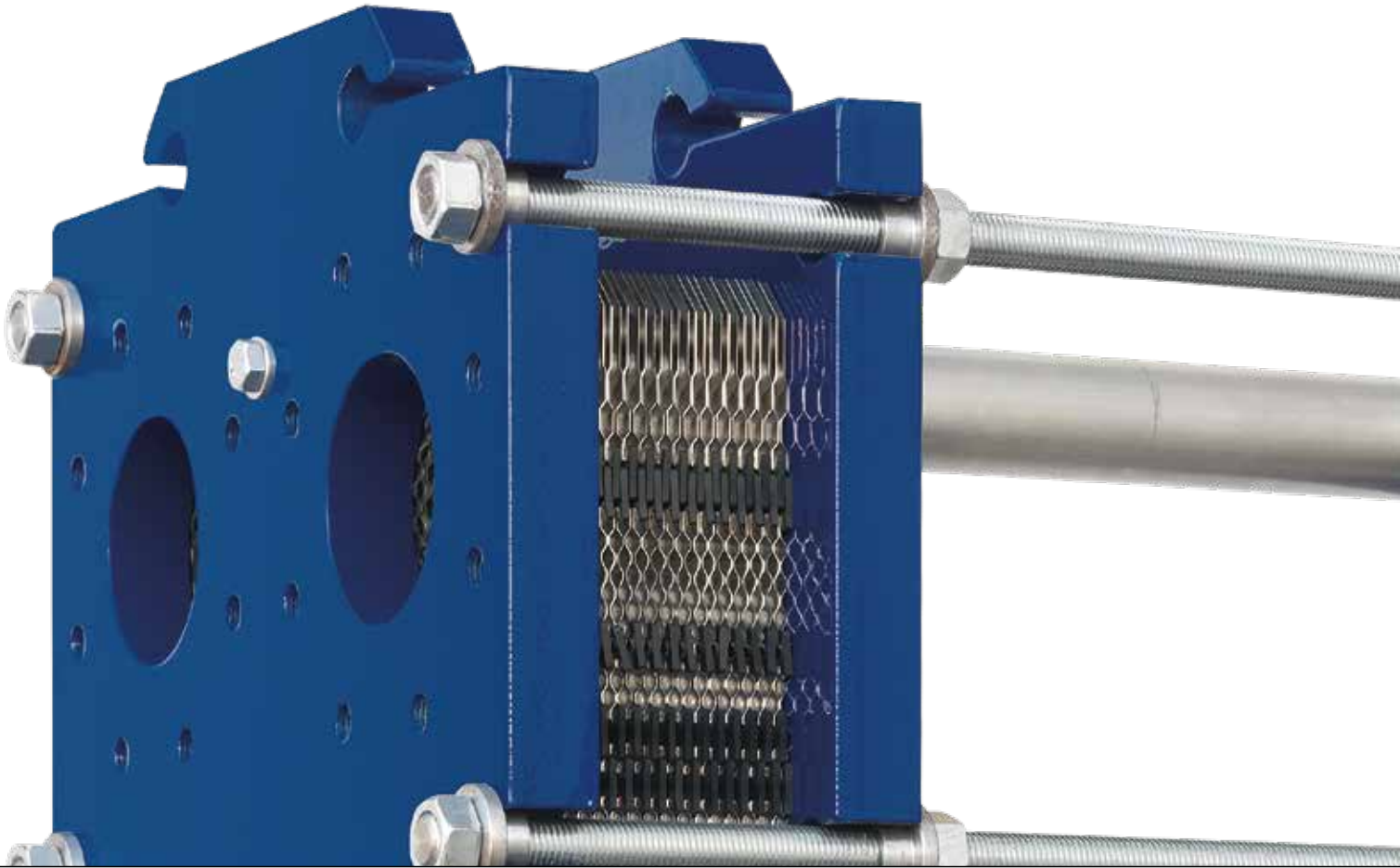

Gasketed Plate heat exchangers

As a specialist of various kinds of heat exchangers, Onda offers a range of gasketed plate heat exchangers.

The gasketed Plate heat exchangers are available in various models and dimensions and frequently offer the best solution for a great variety of heat exchange applications coming from both the HVAC and industries such as the power industry, marine, chemical, heavy industry etc., as well as cogeneration and district heating-and cooling applications.

Description:

The plates are available in two different designs, both in H (high efficiency) and L (low fouling), enabling pressure drop optimization through the combination of both plates. The gaskets have been designed with the Easyfix system in order to enable an easy fastening of the gaskets to the plates and guarantee perfect leak-tightness.

Certifications:

ISO 9001 Vision 2000
P.E.D. (European pressure Directive 97/23 CE)
ASME (on request)

Materials:

Frame: Carbon steel, painted
Plates: AISI 316L / TITANIUM / AISI 304L
Gaskets: NBR (212°F max) / EPDM (248°F max) / HNBR (300°F max) EPDM H HT (280°F max)
Tightening bolts: galvanized steel
Connections: AISI 304 / AISI 316 / PVC / POM-C

Optional:

Insulations available on request
Casing in formed Stainless Steel AISI 304 or Aluminium
Internal insulating material Armaflex thickness 16mm
Mounting feet
Stainless steel frame



ONDA S.p.A.

Via Vittoria, 158/A - 36065 Mussolente (VI) Italy Tel.+39 0444 720720

MODEL	GT15 155 00-66-11 316L		
CODE	RJ015N155AAA		
SIDE	F1,F2		W1,W2
TIGHTENING MEASURE (mm)	48,1 mm		
MIN/MAX ALLOWABLE TEMP. (TS)	°100+ / °10- °C		°100+ / °10- °C
MAX ALLOWABLE PRESSURE (PS)	10 bar	10 bar	
TEST PRESSURE (PT)	16 bar	16 bar	
VOLUME (V)	117,8 L	117,8 L	
FLUID GROUP	WATER		
BUILT	12-11-2019		
SERIAL NUMBER	R1910634-002		
According to art.4, para.3 PED Directive 2014/68/UE			

Progressive number to identify size & type connection

Numer of plates

Gasket

E = EPDM
N = NBR
H = HNBR
R = EPDM H HT
V = VITON

Model G3/4/5/6/7/8/9/10/12/15/21/22/25

Code:	RJ	<div></div>	<div></div>	<div></div>	<div></div>				
Model:	GG	<div></div>	-	<div></div>	-	<div></div>	-	<div></div>	<div></div>

Model

Numbers of plates

Plate configuration H / M / L

Plate material

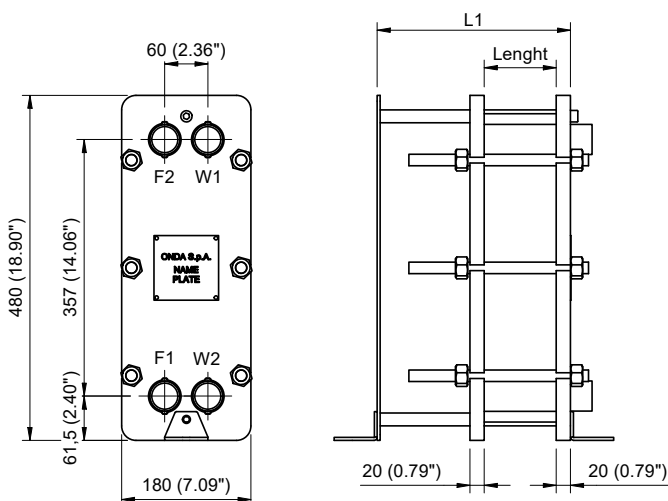
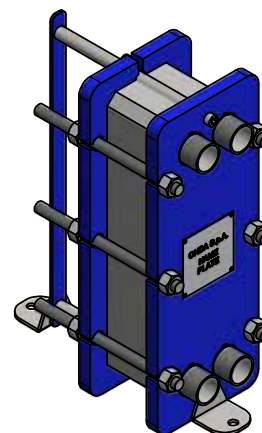
Connections : 1¹/₄ NPT Male

L1							
N° plate	0-25	26-50	51-75	76-100	101-150	151-200	201-250
GG003 (0,114")	9,84"	13"	19,7"	19,7"	NO	NO	NO

SPECIFICATIONS	GG003 150lb	GG003 300lb
PRESSURE RANGE (psi)	150	250
TEMPERATURE RANGE (°F) NBR	14°F to 212°F	14°F to 212°F
TEMPERATURE RANGE (°F) EPDM	14°F to 248°F	14°F to 248°F
MAXIMUM CONNECTIONS AVAILABLE (in.)	Ø 1,34"	Ø 1,34"
MAXIMUM FLOW RATE (gpm)	80	80
VOLUME / CHANNEL (US gal)	0,02	0,02
DIMENSIONS (in.)	7,09"x19,88"	7,09"x19,88"
LENGHT CALCULATION (in)	N x 0,114"	N x 0,114"
WEIGHT CALCULATION (lbs)	(N x 0,44) + 68	(N x 0,44) + 68

CONNECTIONS TYPE
1" 1/4 NPT

F1 INLET CIRCUIT 1
 F2 OUTLET CIRCUIT 1
 W1 INLET Secondary Fluid
 W2 OUTLET Secondary Fluid

Plate material AISI 304L / AISI 316L / TITANIUM
 Plate thickness 0,02"
 Gasket material NBR / EPDM / VITON / HNBR / EPDM H HT
 Frame material CARBON STEEL
 Frame colour RAL 5002 SEMIGLOSS FINISHING
 Tie rod N° 6 GALVANIZED CLASS 8.8
 Material connections AISI 304 / AISI 316 / POM-C

GG004

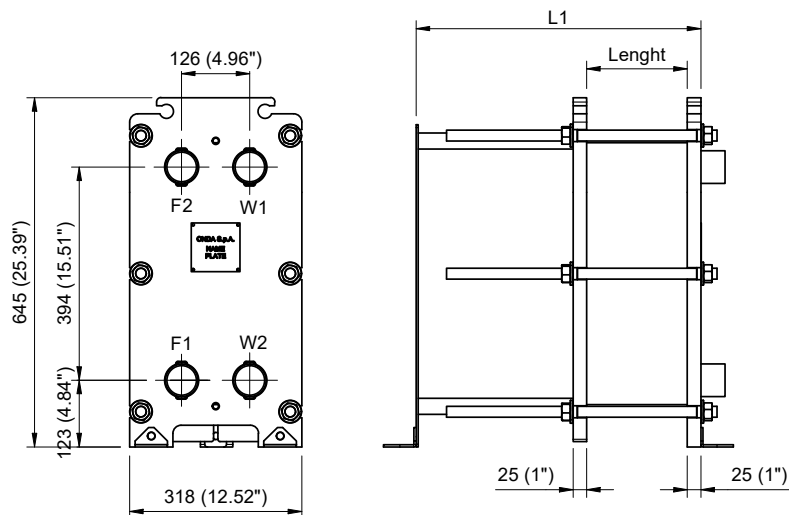

Connections : 2" NPT Male

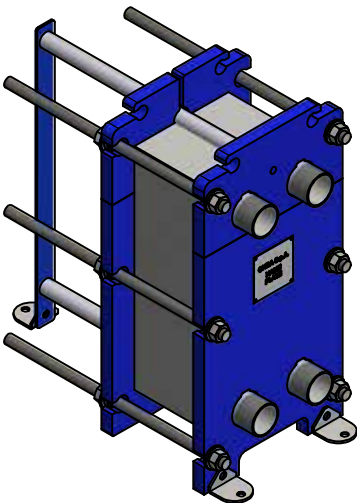

L1							
N° plate	0-25	26-50	51-75	76-100	101-150	151-200	201-250
GG004 (0,118")	9,84"	13"	19,7"	29,5"	29,5"	NO	NO

SPECIFICATIONS	GG004 150lb	GG004 300lb
PRESSURE RANGE (psi)	150	250
TEMPERATURE RANGE (°F) NBR	14°F to 212°F	14°F to 212°F
TEMPERATURE RANGE (°F) EPDM	14°F to 248°F	14°F to 248°F
MAXIMUM CONNECTIONS AVAILABLE (in.)	Ø 2,3"	Ø 2,3"
MAXIMUM FLOW RATE (gpm)	228	228
VOLUME / CHANNEL (US gal)	0,035	0,035
DIMENSIONS (in.)	12,5"x25,39"	12,5"x25,39"
LENGHT CALCULATION (in)	N x 0,118"	N x 0,118"
WEIGHT CALCULATION (lbs)	(N x 1) + 200	(N x 1) + 200

CONNECTIONS TYPE
2" NPT

- F1 INLET CIRCUIT 1
F2 OUTLET CIRCUIT 1
W1 INLET Secondary Fluid
W2 OUTLET Secondary Fluid

Plate material AISI 304L / AISI 316L / TITANIUM
Plate thickness 0,02"
Gasket material NBR / EPDM / VITON / HNBR / EPDM H HT
Frame material CARBON STEEL
Frame colour RAL 5002 SEMIGLOSS FINISHING
Tie rod N° 6 GALVANIZED CLASS 8.8
Material connections AISI 304 / AISI 316 / POM-C

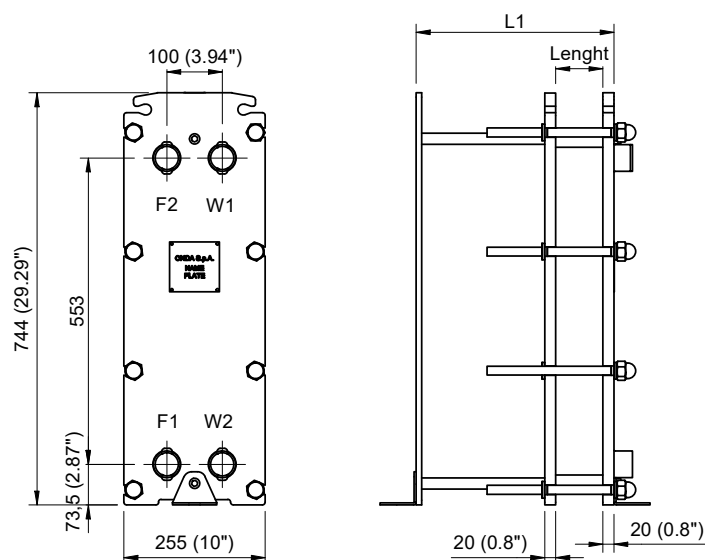

Connections : 1"1/2 NPT Male

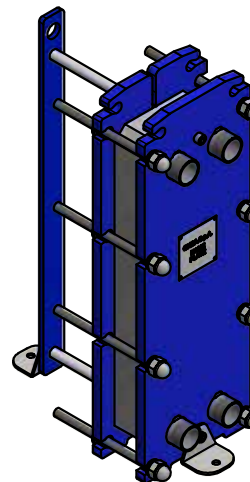

L1							
N° plate	0-25	26-50	51-75	76-100	101-150	151-200	201-250
GG005 (0,134'')	9,84''	13''	19,7''	19,7''	NO	NO	NO

SPECIFICATIONS	GG005 150lb	GG005 300lb
PRESSURE RANGE (psi)	150	250
TEMPERATURE RANGE (°F) NBR	14°F to 212°F	14°F to 212°F
TEMPERATURE RANGE (°F) EPDM	14°F to 248°F	14°F to 248°F
MAXIMUM CONNECTIONS AVAILABLE (in.)	Ø 0,15''	Ø 0,15''
MAXIMUM FLOW RATE (gpm)	100	100
VOLUME / CHANNEL (US gal)	0,063	0,063
DIMENSIONS (in.)	10"x29,3"	10"x29,3"
LENGHT CALCULATION (in)	N x 0,134''	N x 0,134''
WEIGHT CALCULATION (lbs)	(N x 1,10) + 136	(N x 1,10) + 136

CONNECTIONS TYPE
1" 1/2 NPT

F1 INLET CIRCUIT 1
 F2 OUTLET CIRCUIT 1
 W1 INLET Secondary Fluid
 W2 OUTLET Secondary Fluid

Plate material AISI 304L / AISI 316L / TITANIUM
 Plate thickness 0,02''
 Gasket material NBR / EPDM / VITON / HNBR / EPDM H HT
 Frame material CARBON STEEL
 Frame colour RAL 5002 SEMIGLOSS FINISHING
 Tie rod N° 6 GALVANIZED CLASS 8.8
 Material connections AISI 304 / AISI 316 / POM-C

GG006

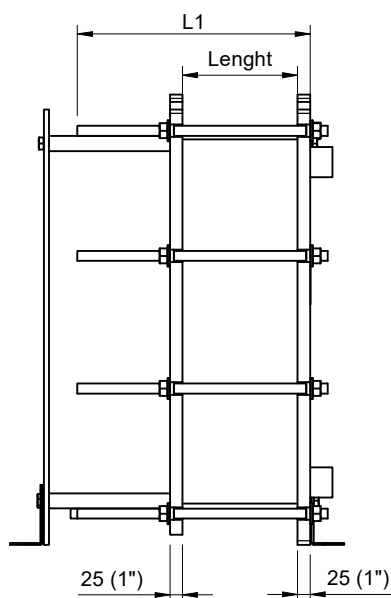
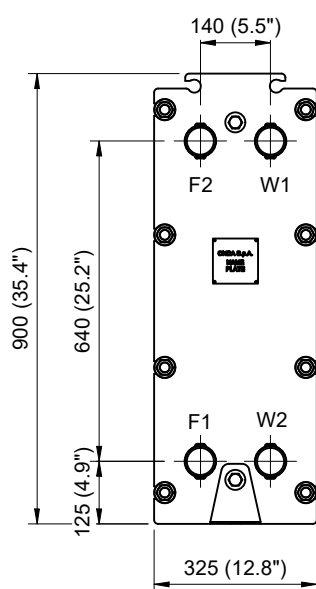

Connections : 2" NPT Male

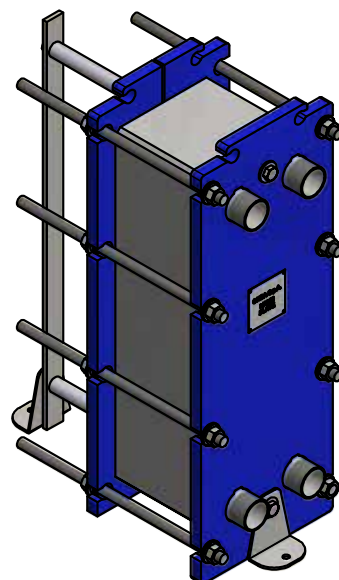

L1							
N° plate	0-25	26-50	51-75	76-100	101-150	151-200	201-250
GG006 (0,138")	9,84"	13"	19,7"	29,5"	39,4"	NO	NO

SPECIFICATIONS	GG006 150lb	GG006 300lb
PRESSURE RANGE (psi)	150	250
TEMPERATURE RANGE (°F) NBR	14°F to 212°F	14°F to 212°F
TEMPERATURE RANGE (°F) EPDM	14°F to 248°F	14°F to 248°F
MAXIMUM CONNECTIONS AVAILABLE (in.)	Ø 2,2"	Ø 2,2"
MAXIMUM FLOW RATE (gpm)	200	200
VOLUME / CHANNEL (US gal)	0,11	0,11
DIMENSIONS (in.)	12,8"x35,4"	12,8"x35,4"
LENGHT CALCULATION (in)	N x 0,138"	N x 0,138"
WEIGHT CALCULATION (lbs)	(N x 1,5) + 275	(N x 1,5) + 275

CONNECTIONS TYPE
2" NPT

F1 INLET CIRCUIT 1
 F2 OUTLET CIRCUIT 1
 W1 INLET Secondary Fluid
 W2 OUTLET Secondary Fluid

Plate material AISI 304L / AISI 316L / TITANIUM
 Plate thickness 0,02"
 Gasket material NBR / EPDM / VITON / HNBR / EPDM H HT
 Frame material CARBON STEEL
 Frame colour RAL 5002 SEMIGLOSS FINISHING
 Tie rod N° 6 GALVANIZED CLASS 8.8
 Material connections AISI 304 / AISI 316 / POM-C

Connections : 2" NPT Male

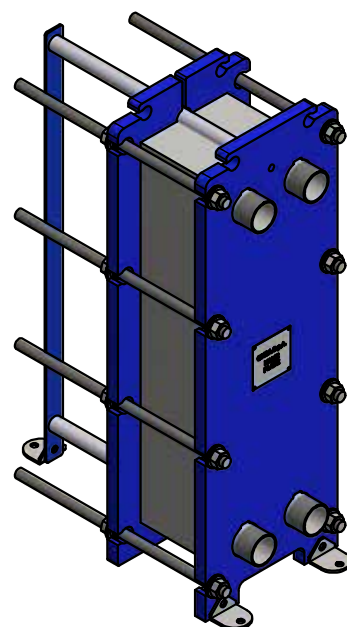
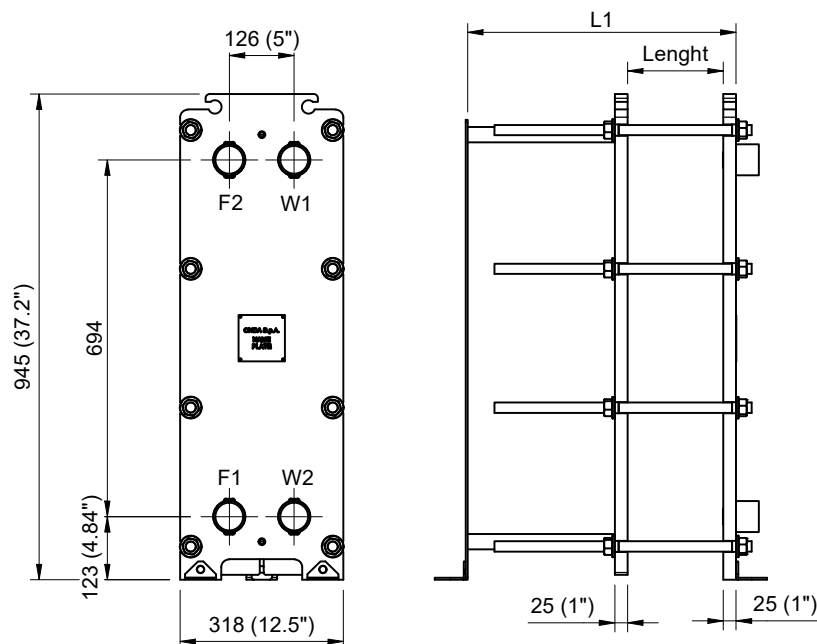

L1							
N° plate	0-25	26-50	51-75	76-100	101-150	151-200	201-250
GG007 (0,118")	9,84"	13"	19,7"	29,5"	39,4"	NO	NO

SPECIFICATIONS	GG007 150lb	GG007 300lb
PRESSURE RANGE (psi)	150	250
TEMPERATURE RANGE (°F) NBR	14°F to 212°F	14°F to 212°F
TEMPERATURE RANGE (°F) EPDM	14°F to 248°F	14°F to 248°F
MAXIMUM CONNECTIONS AVAILABLE (in.)	Ø 2,28"	Ø 2,28"
MAXIMUM FLOW RATE (gpm)	200	200
VOLUME / CHANNEL (US gal)	0,11	0,11
DIMENSIONS (in.)	12,5"x37,2"	12,5"x37,2"
LENGHT CALCULATION (in)	N x 0,118"	N x 0,118"
WEIGHT CALCULATION (lbs)	(N x 1,65) + 290	(N x 1,65) + 290

CONNECTIONS TYPE
2" NPT

F1 INLET CIRCUIT 1
 F2 OUTLET CIRCUIT 1
 W1 INLET Secondary Fluid
 W2 OUTLET Secondary Fluid

Plate material AISI 304L / AISI 316L / TITANIUM
 Plate thickness 0,02"
 Gasket material NBR / EPDM / VITON / HNBR / EPDM H HT
 Frame material CARBON STEEL
 Frame colour RAL 5002 SEMIGLOSS FINISHING
 Tie rod N° 6 GALVANIZED CLASS 8.8
 Material connections AISI 304 / AISI 316 / POM-C

GG008

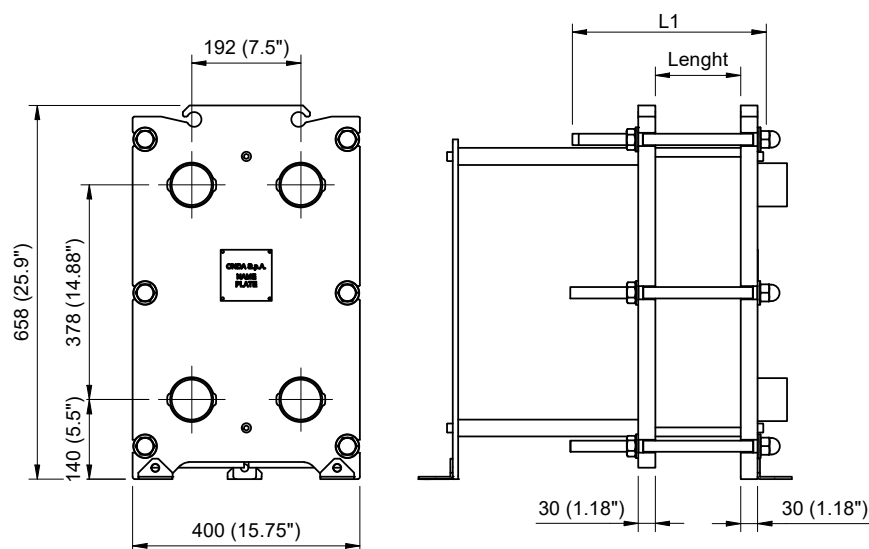

Connections : 2"1/2 NPT Male

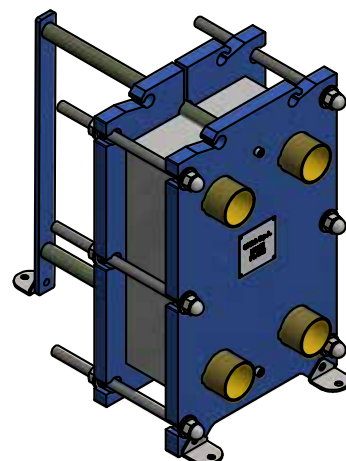

L1							
N° plate	0-25	26-50	51-75	76-100	101-150	151-200	201-250
GG008 (0,106")	13"	19,7"	29,5"	29,5"	39,5"	39,5"	NO

SPECIFICATIONS	GG008 150lb	GG008 300lb
PRESSURE RANGE (psi)	150	250
TEMPERATURE RANGE (°F) NBR	14°F to 212°F	14°F to 212°F
TEMPERATURE RANGE (°F) EPDM	14°F to 248°F	14°F to 248°F
MAXIMUM CONNECTIONS AVAILABLE (in.)	Ø 2,7"	Ø 2,7"
MAXIMUM FLOW RATE (gpm)	300	300
VOLUME / CHANNEL (US gal)	0,042	0,042
DIMENSIONS (in.)	15,75"x25,9"	15,75"x25,9"
LENGHT CALCULATION (in)	N x 0,106"	N x 0,106"
WEIGHT CALCULATION (lbs)	(N x 1,32) + 264	(N x 1,32) + 264

CONNECTIONS TYPE
2" 1/2 NPT

F1 INLET CIRCUIT 1
 F2 OUTLET CIRCUIT 1
 W1 INLET Secondary Fluid
 W2 OUTLET Secondary Fluid

Plate material AISI 304L / AISI 316L / TITANIUM
 Plate thickness 0,02"
 Gasket material NBR / EPDM / VITON / HNBR / EPDM H HT
 Frame material CARBON STEEL
 Frame colour RAL 5002 SEMIGLOSS FINISHING
 Tie rod N° 6 GALVANIZED CLASS 8.8
 Material connections AISI 304 / AISI 316 / POM-C

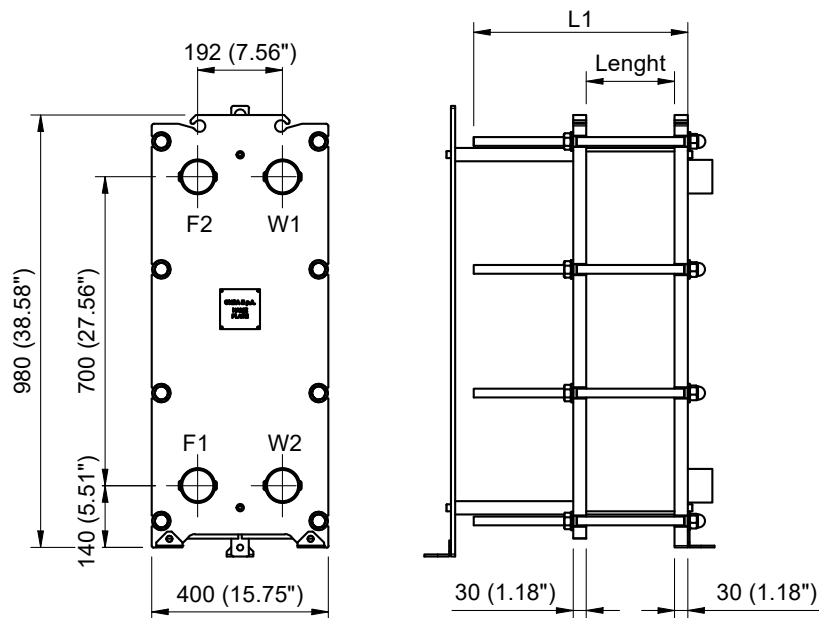

Connections : 2"1/2 NPT Male

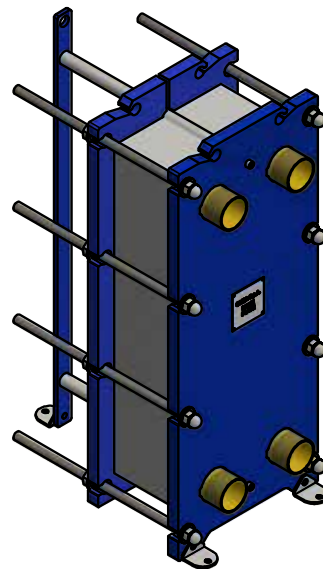

L1							
N° plate	0-25	26-50	51-75	76-100	101-150	151-200	201-250
GG009 (0,10")	13"	19,7"	29,5"	29,5"	39,3"	39,3"	NO

SPECIFICATIONS	GG009 150lb	GG009 300lb
PRESSURE RANGE (psi)	150	250
TEMPERATURE RANGE (°F) NBR	14°F to 212°F	14°F to 212°F
TEMPERATURE RANGE (°F) EPDM	14°F to 248°F	14°F to 248°F
MAXIMUM CONNECTIONS AVAILABLE (in.)	Ø 2,7"	Ø 2,7"
MAXIMUM FLOW RATE (gpm)	300	300
VOLUME / CHANNEL (US gal)	0,1	0,1
DIMENSIONS (in.)	15,75"x38,5"	15,75"x38,5"
LENGHT CALCULATION (in)	N x 0,1"	N x 0,1"
WEIGHT CALCULATION (lbs)	(N x 2,20) + 400	(N x 2,20) + 400

CONNECTIONS TYPE
2" 1/2 NPT

F1 INLET CIRCUIT 1
 F2 OUTLET CIRCUIT 1
 W1 INLET Secondary Fluid
 W2 OUTLET Secondary Fluid

Plate material AISI 304L / AISI 316L / TITANIUM
 Plate thickness 0,02"
 Gasket material NBR / EPDM / VITON / HNBR / EPDM H HT
 Frame material CARBON STEEL
 Frame colour RAL 5002 SEMIGLOSS FINISHING
 Tie rod N° 6 GALVANIZED CLASS 8.8
 Material connections AISI 304 / AISI 316 / POM-C

GG010

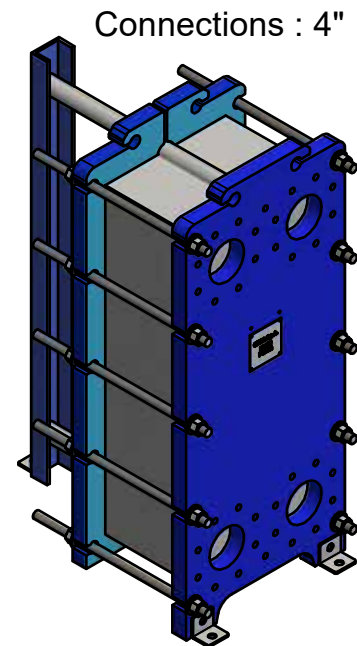
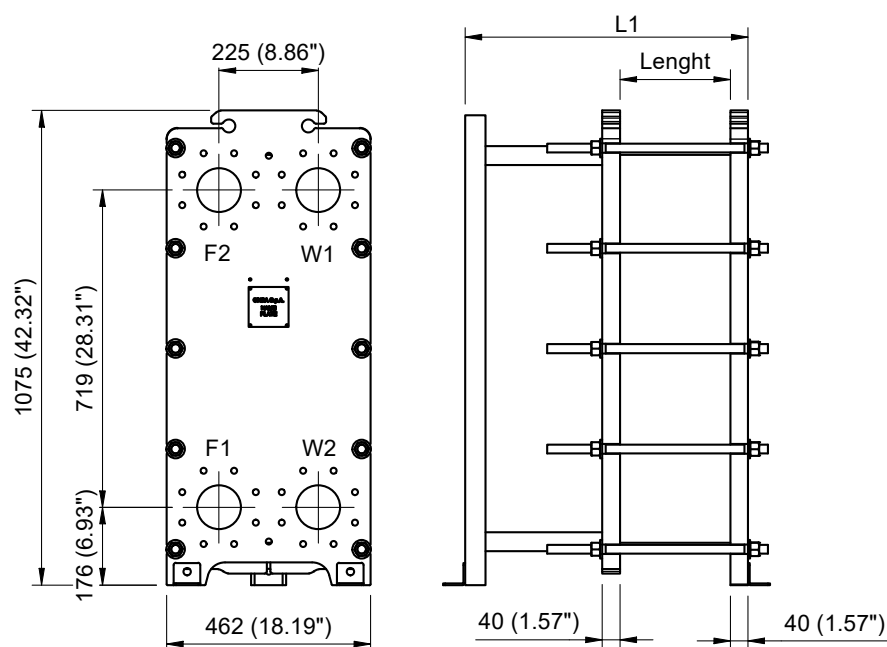

L1							
N° plate	0-25	26-50	51-75	76-100	101-150	151-200	201-250
GG010 (0,122")	19,7"	19,7"	29,5"	29,5"	39,3"	59"	59"

SPECIFICATIONS	GG010 150lb	GG010 300lb
PRESSURE RANGE (psi)	150	250
TEMPERATURE RANGE (°F) NBR	14°F to 212°F	14°F to 212°F
TEMPERATURE RANGE (°F) EPDM	14°F to 248°F	14°F to 248°F
MAXIMUM CONNECTIONS AVAILABLE (in.)	Ø 4"	Ø 4"
MAXIMUM FLOW RATE (gpm)	660	660
VOLUME / CHANNEL (US gal)	0,16	0,16
DIMENSIONS (in.)	18,18"x42,3"	18,18"x42,3"
LENGHT CALCULATION (in)	N x 0,122"	N x 0,122"
WEIGHT CALCULATION (lbs)	(N x 2,8) + 582	(N x 2,8) + 582

CONNECTIONS TYPE
4" - 150lb

F1 INLET CIRCUIT 1
 F2 OUTLET CIRCUIT 1
 W1 INLET Secondary Fluid
 W2 OUTLET Secondary Fluid

Plate material AISI 304L / AISI 316L / TITANIUM
 Plate thickness 0,02"
 Gasket material NBR / EPDM / VITON / HNBR / EPDM H HT
 Frame material CARBON STEEL
 Frame colour RAL 5002 SEMIGLOSS FINISHING
 Tie rod N° 6 GALVANIZED CLASS 8.8

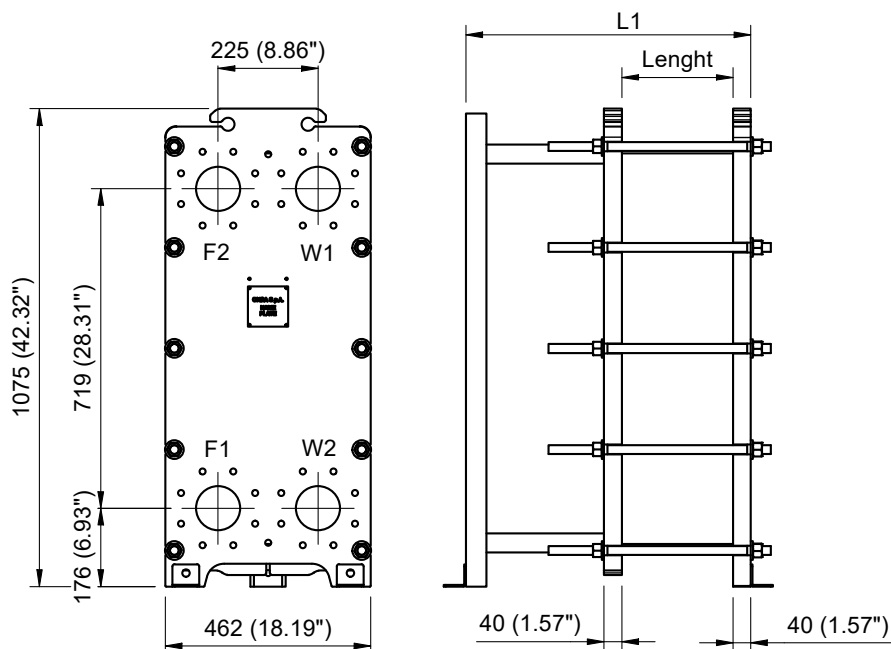

Connections : 4"

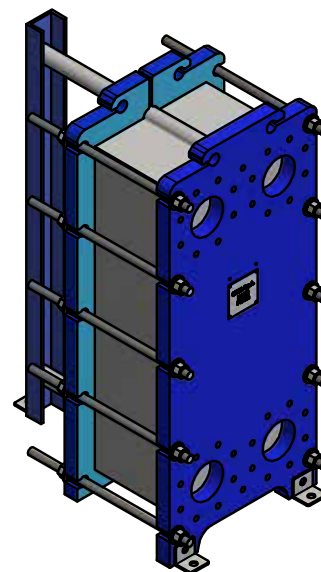

L1							
N° plate	0-25	26-50	51-75	76-100	101-150	151-200	201-250
GM010 (0,177")	19,7"	29,5"	39,3"	39,3"	59"	59"	NO

SPECIFICATIONS	GM010 150lb	GM010 300lb
PRESSURE RANGE (psi)	150	250
TEMPERATURE RANGE (°F) NBR	14°F to 212°F	14°F to 212°F
TEMPERATURE RANGE (°F) EPDM	14°F to 248°F	14°F to 248°F
MAXIMUM CONNECTIONS AVAILABLE (in.)	Ø 4"	Ø 4"
MAXIMUM FLOW RATE (gpm)	660	660
VOLUME / CHANNEL (US gal)	0,25	0,25
DIMENSIONS (in.)	18,18"x42,3"	18,18"x42,3"
LENGHT CALCULATION (in)	N x 0,177"	N x 0,177"
WEIGHT CALCULATION (lbs)	(N x 3) + 582	(N x 3) + 582

CONNECTIONS TYPE
4" - 150lb

F1 INLET CIRCUIT 1
 F2 OUTLET CIRCUIT 1
 W1 INLET Secondary Fluid
 W2 OUTLET Secondary Fluid

Plate material AISI 304L / AISI 316L / TITANIUM
 Plate thickness 0,02"
 Gasket material NBR / EPDM / VITON / HNBR / EPDM H HT
 Frame material CARBON STEEL
 Frame colour RAL 5002 SEMIGLOSS FINISHING
 Tie rod N° 6 GALVANIZED CLASS 8.8

GT012

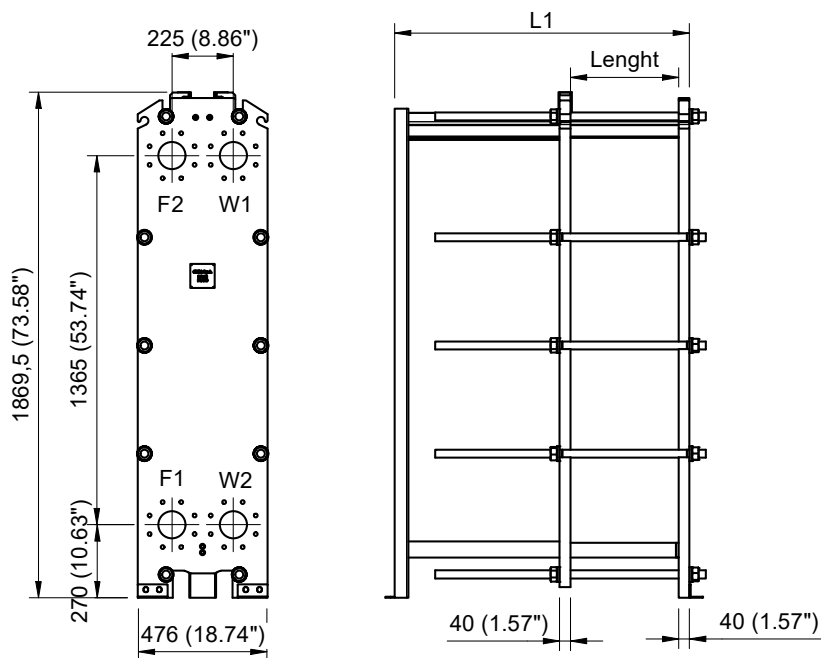

Connections : 4"

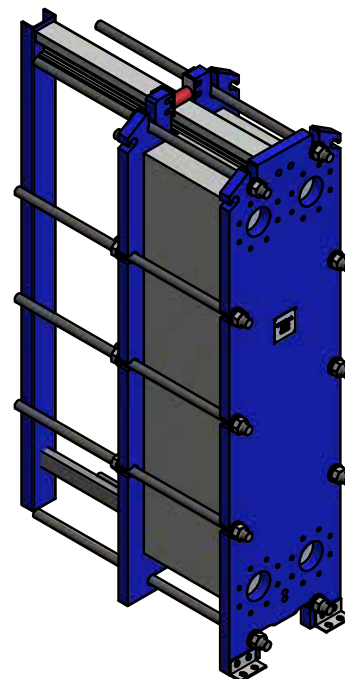

L1								
N° plate	0-25	26-50	51-75	76-100	101-150	151-200	201-250	251-300
GT012 (0,12")	39"	39"	39"	39"	39"	59"	59"	59"

SPECIFICATIONS	GT012 150lb	GT012 300lb
PRESSURE RANGE (psi)	150	250
TEMPERATURE RANGE (°F) NBR	14°F to 212°F	14°F to 212°F
TEMPERATURE RANGE (°F) EPDM	14°F to 248°F	14°F to 248°F
MAXIMUM CONNECTIONS AVAILABLE (in.)	Ø 4"	Ø 4"
MAXIMUM FLOW RATE (gpm)	660	660
VOLUME / CHANNEL (US gal)	0,33	0,33
DIMENSIONS (in.)	19"x73,5"	18,18"x42,3"
LENGHT CALCULATION (in)	N x 0,12"	N x 0,12"
WEIGHT CALCULATION (lbs)	(N x 4,8) + 1280	(N x 4,8) + 1280

CONNECTIONS TYPE
4" - 150lb

F1 INLET CIRCUIT 1
 F2 OUTLET CIRCUIT 1
 W1 INLET Secondary Fluid
 W2 OUTLET Secondary Fluid

Plate material AISI 304L / AISI 316L / TITANIUM
 Plate thickness 0,02"
 Gasket material NBR / EPDM / VITON / HNBR / EPDM H HT
 Frame material CARBON STEEL
 Frame colour RAL 5002 SEMIGLOSS FINISHING
 Tie rod N° 6 GALVANIZED CLASS 8.8

Connections : 6"

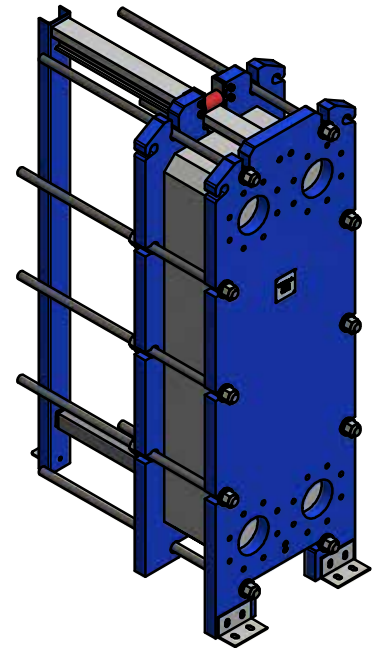
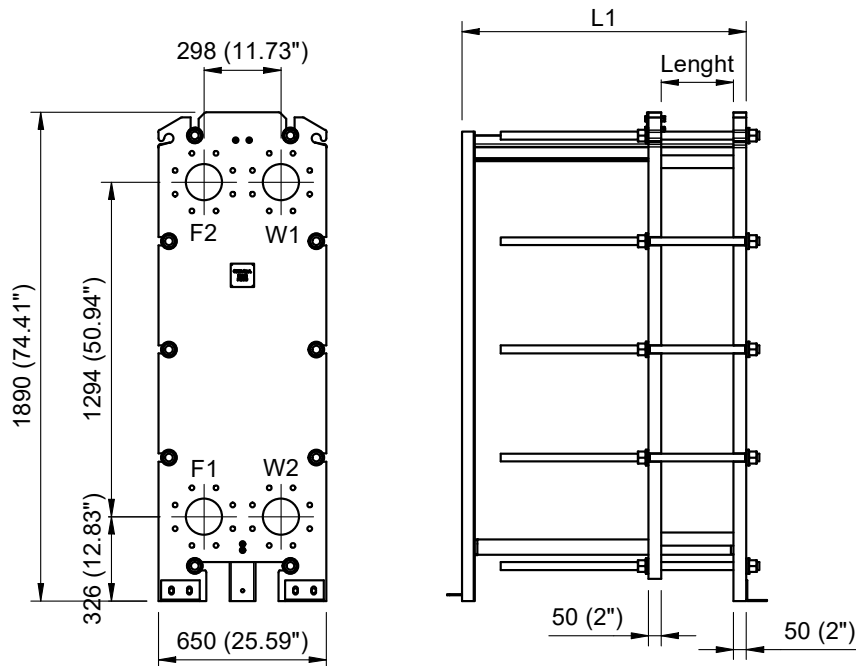

L1									
N° plate	0-25	26-50	51-75	76-100	101-150	151-200	201-250	251-300	301-350
GT015 (0,12")	39"	39"	39"	39"	39"	59"	59"	59"	78"

SPECIFICATIONS	GT015 150lb	GT015 300lb
PRESSURE RANGE (psi)	150	250
TEMPERATURE RANGE (°F) NBR	14°F to 212°F	14°F to 212°F
TEMPERATURE RANGE (°F) EPDM	14°F to 248°F	14°F to 248°F
MAXIMUM CONNECTIONS AVAILABLE (in.)	Ø 6"	Ø 6"
MAXIMUM FLOW RATE (gpm)	1300	1300
VOLUME / CHANNEL (US gal)	0,40	0,40
DIMENSIONS (in.)	25,6"x74,4"	25,6"x74,4"
LENGHT CALCULATION (in)	N x 0,12"	N x 0,12"
WEIGHT CALCULATION (lbs)	(N x 6) + 2100	(N x 6) + 2100

CONNECTIONS TYPE
6" - 150lb

F1 INLET CIRCUIT 1
F2 OUTLET CIRCUIT 1
W1 INLET Secondary Fluid
W2 OUTLET Secondary Fluid

Plate material	AISI 304L / AISI 316L / TITANIUM
Plate thickness	0,02"
Gasket material	NBR / EPDM / VITON / HNBR / EPDM H HT
Frame material	CARBON STEEL
Frame colour	RAL 5002 SEMIGLOSS FINISHING
Tie rod	N° 6 GALVANIZED CLASS 8.8

GP015

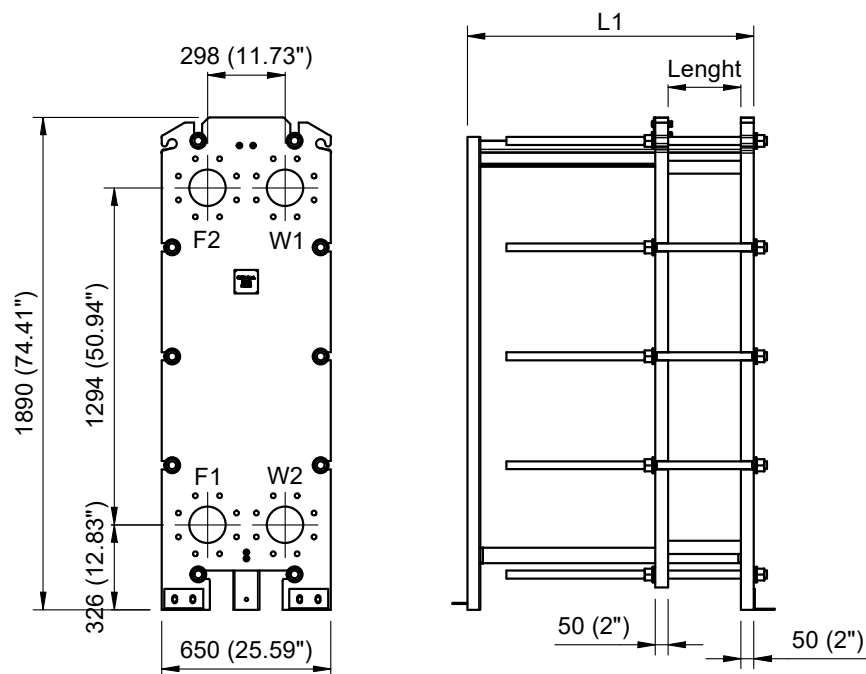

Connections : 6"

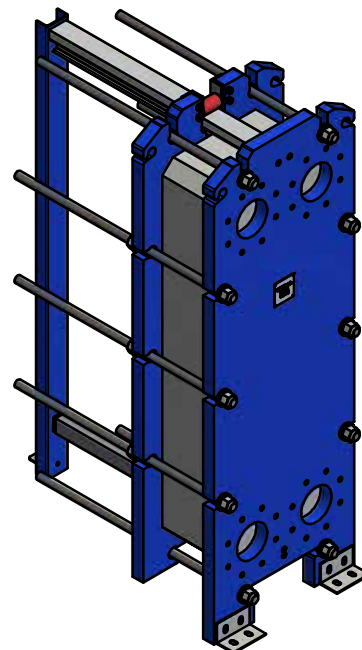

L1									
N° plate	0-25	26-50	51-75	76-100	101-150	151-200	201-250	251-300	301-350
GP015 (0,17'')	39''	39''	39''	39''	59''	59''	59''	78''	118''

SPECIFICATIONS	GT015 150lb	GT015 300lb
PRESSURE RANGE (psi)	150	250
TEMPERATURE RANGE (°F) NBR	14°F to 212°F	14°F to 212°F
TEMPERATURE RANGE (°F) EPDM	14°F to 248°F	14°F to 248°F
MAXIMUM CONNECTIONS AVAILABLE (in.)	Ø 6"	Ø 6"
MAXIMUM FLOW RATE (gpm)	1300	1300
VOLUME / CHANNEL (US gal)	0,65	0,65
DIMENSIONS (in.)	25,6"x74,4"	25,6"x74,4"
LENGHT CALCULATION (in)	N x 0,17"	N x 0,17"
WEIGHT CALCULATION (lbs)	(N x 6) + 2100	(N x 6) + 2100

CONNECTIONS TYPE
6" - 150lb

F1 INLET CIRCUIT 1
 F2 OUTLET CIRCUIT 1
 W1 INLET Secondary Fluid
 W2 OUTLET Secondary Fluid

Plate material AISI 304L / AISI 316L / TITANIUM
 Plate thickness 0,02"
 Gasket material NBR / EPDM / VITON / HNBR / EPDM H HT
 Frame material CARBON STEEL
 Frame colour RAL 5002 SEMIGLOSS FINISHING
 Tie rod N° 6 GALVANIZED CLASS 8.8

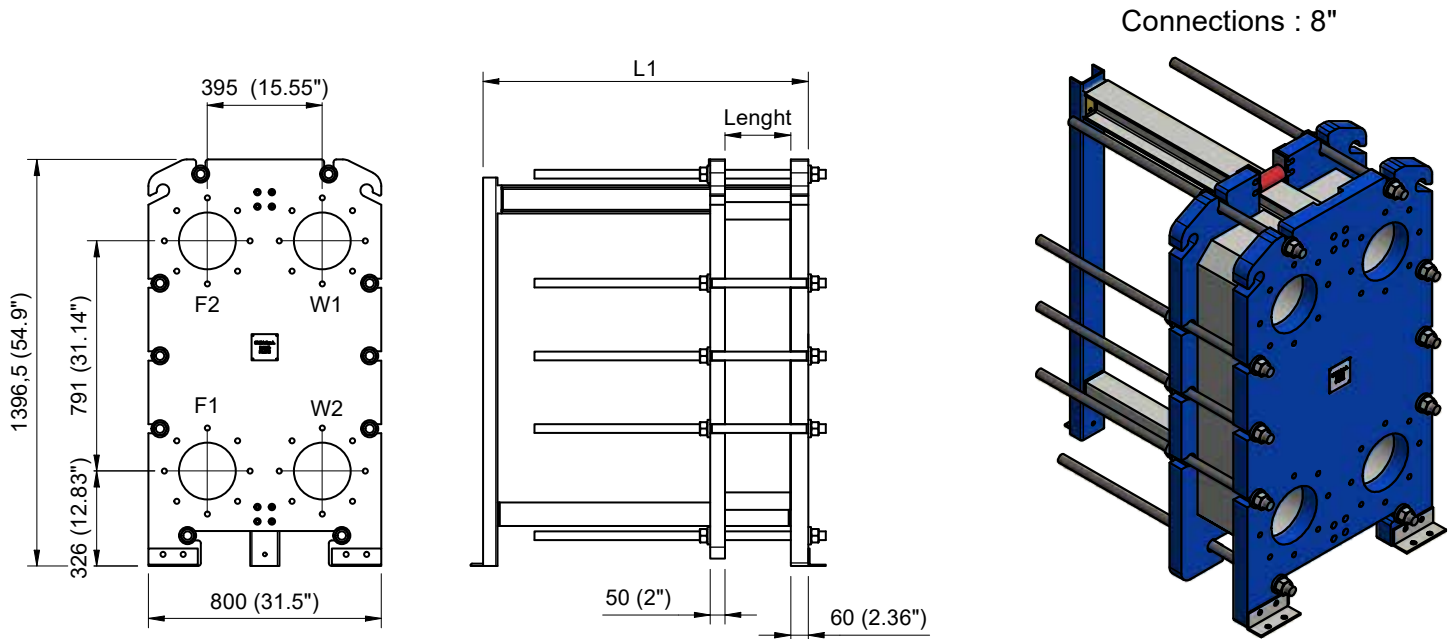

L1											
N° plate	0-25	26-50	51-75	76-100	101-150	151-200	201-250	250-300	301-350	351-400	401-450
GT021 (3,1)	39"	39"	39"	39"	39"	59"	59"	59"	78"	118"	118"

SPECIFICATIONS	GT021 150lb	GT021 300lb
PRESSURE RANGE (psi)	150	250
TEMPERATURE RANGE (°F) NBR	14°F to 212°F	14°F to 212°F
TEMPERATURE RANGE (°F) EPDM	14°F to 248°F	14°F to 248°F
MAXIMUM CONNECTIONS AVAILABLE (in.)	Ø 8"	Ø 8"
MAXIMUM FLOW RATE (gpm)	2500	2500
VOLUME / CHANNEL (US gal)	0,30	0,30
DIMENSIONS (in.)	31,5"x55"	31,5"x55"
LENGHT CALCULATION (in)	N x 0,12"	N x 0,12"
WEIGHT CALCULATION (lbs)	(N x 5) + 2000	(N x 5) + 2000

CONNECTIONS TYPE
8" - 150lb

F1 INLET CIRCUIT 1
F2 OUTLET CIRCUIT 1
W1 INLET Secondary Fluid
W2 OUTLET Secondary Fluid

Plate material AISI 304L / AISI 316L / TITANIUM
 Plate thickness 0,02"
 Gasket material NBR / EPDM / VITON / HNBR / EPDM H HT
 Frame material CARBON STEEL
 Frame colour RAL 5002 SEMIGLOSS FINISHING
 Tie rod N° 6 GALVANIZED CLASS 8.8

GT022

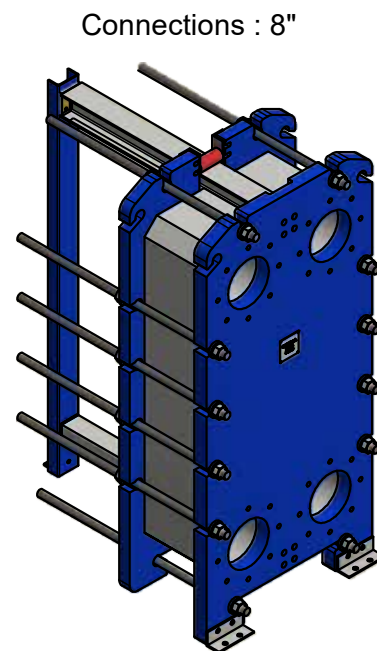
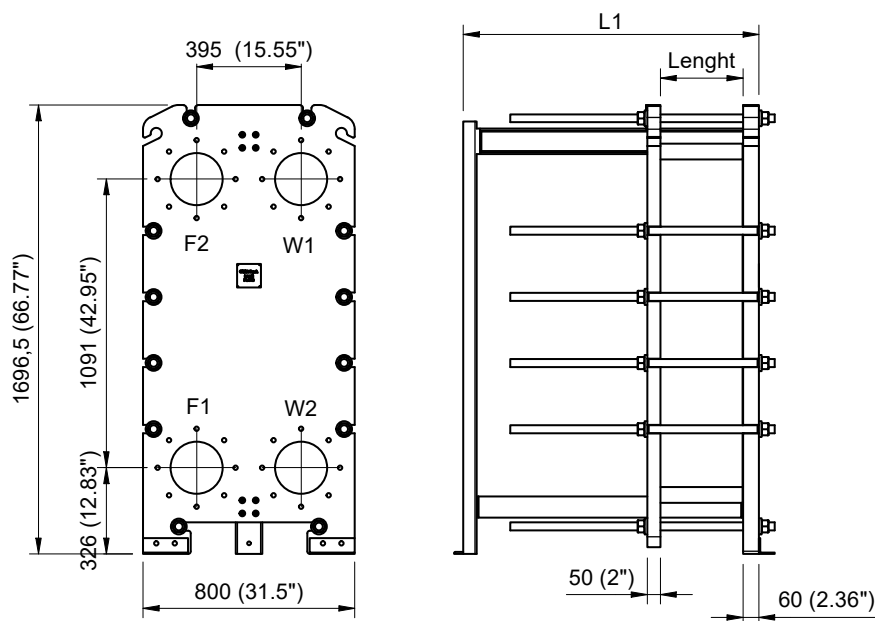

L1											
N° plate	0-25	26-50	51-75	76-100	101-150	151-200	201-250	250-300	301-350	351-400	401-450
GT022 (0,12")	39"	39"	39"	39"	39"	59"	59"	59"	78"	118"	118"

SPECIFICATIONS	GT022 150lb	GT022 300lb
PRESSURE RANGE (psi)	150	250
TEMPERATURE RANGE (°F) NBR	14°F to 212°F	14°F to 212°F
TEMPERATURE RANGE (°F) EPDM	14°F to 248°F	14°F to 248°F
MAXIMUM CONNECTIONS AVAILABLE (in.)	Ø 8"	Ø 8"
MAXIMUM FLOW RATE (gpm)	2500	2500
VOLUME / CHANNEL (US gal)	0,44	0,44
DIMENSIONS (in.)	31,5"x66"	31,5"x66"
LENGHT CALCULATION (in)	N x 0,12"	N x 0,12"
WEIGHT CALCULATION (lbs)	(N x 7) + 2500	(N x 7) + 2500

CONNECTIONS TYPE
8"

F1 INLET CIRCUIT 1
 F2 OUTLET CIRCUIT 1
 W1 INLET Secondary Fluid
 W2 OUTLET Secondary Fluid

Plate material AISI 304L / AISI 316L / TITANIUM
 Plate thickness 0,02"
 Gasket material NBR / EPDM / VITON / HNBR / EPDM H HT
 Frame material CARBON STEEL
 Frame colour RAL 5002 SEMIGLOSS FINISHING
 Tie rod N° 6 GALVANIZED CLASS 8.8

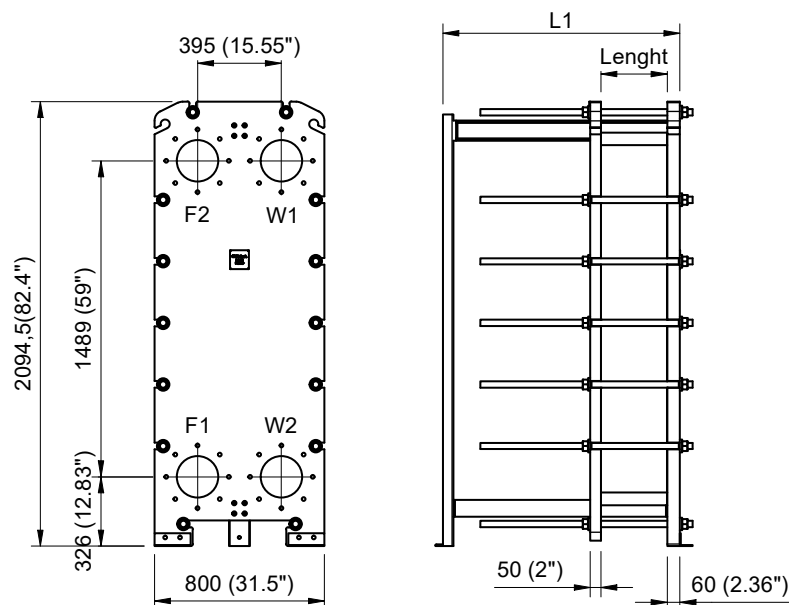

Connections : 8"

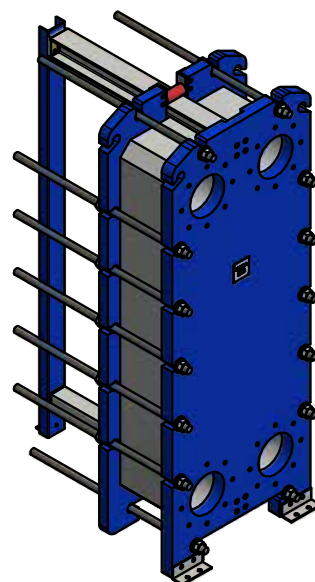

L1											
N° plate	0-25	26-50	51-75	76-100	101-150	151-200	201-250	250-300	301-350	351-400	401-450
GT025 (0,12")	39"	39"	39"	39"	39"	59"	59"	59"	78"	118"	118"

SPECIFICATIONS	GT025 150lb	GT025 300lb
PRESSURE RANGE (psi)	150	250
TEMPERATURE RANGE (°F) NBR	14°F to 212°F	14°F to 212°F
TEMPERATURE RANGE (°F) EPDM	14°F to 248°F	14°F to 248°F
MAXIMUM CONNECTIONS AVAILABLE (in.)	Ø 8"	Ø 8"
MAXIMUM FLOW RATE (gpm)	2500	2500
VOLUME / CHANNEL (US gal)	0,68	0,68
DIMENSIONS (in.)	31,5"x82,5"	31,5"x82,5"
LENGHT CALCULATION (in)	N x 0,12"	N x 0,12"
WEIGHT CALCULATION (lbs)	(N x 10) + 3150	(N x 10) + 3150

CONNECTIONS TYPE
8" -150lb

F1 INLET CIRCUIT 1
 F2 OUTLET CIRCUIT 1
 W1 INLET Secondary Fluid
 W2 OUTLET Secondary Fluid

Plate material AISI 304L / AISI 316L / TITANIUM
 Plate thickness 0,02"
 Gasket material NBR / EPDM / VITON / HNBR / EPDM H HT
 Frame material CARBON STEEL
 Frame colour RAL 5002 SEMIGLOSS FINISHING
 Tie rod N° 6 GALVANIZED CLASS 8.8

Optional :

Coibentazione
(Insulation)

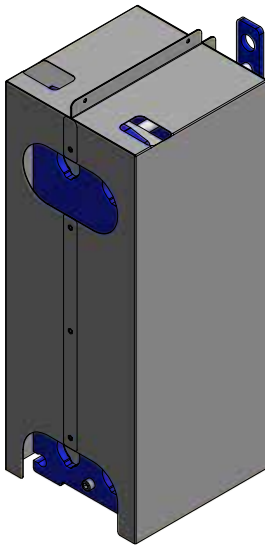

Configurazione 2 passi
(2 passes configuration)

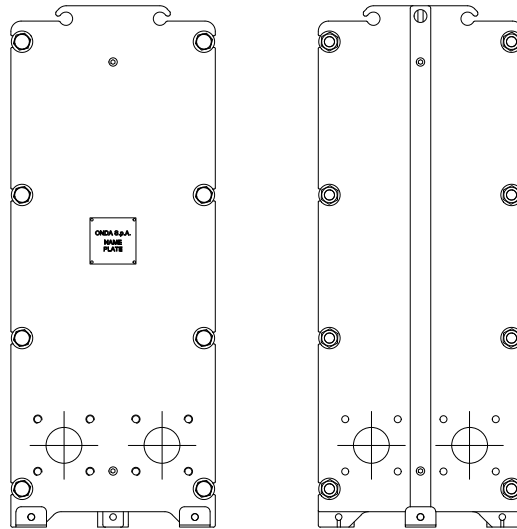

Connessioni speciali a richiesta ove possibile (Special connections if possible)

Collare in gomma
(Rubber connections)

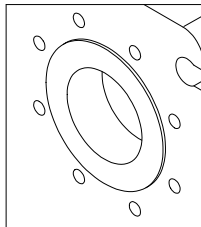

Collare Aisi316
(Aisi 316 collar)

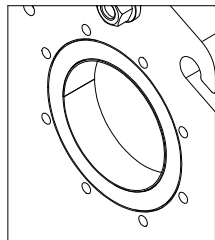

Flangiato
(Flanged)

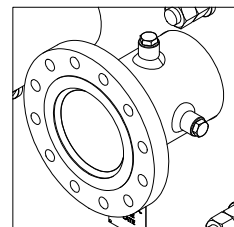

Victaulic

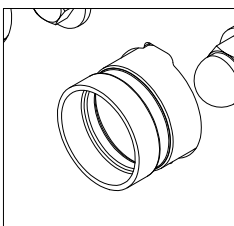

PVC (Bonding)

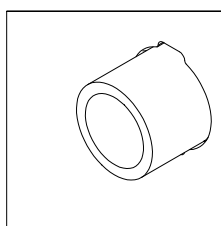

PVC (Threaded Male)

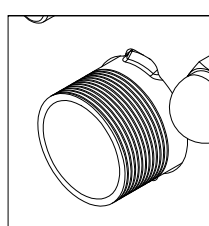

PVC (Threaded Female)

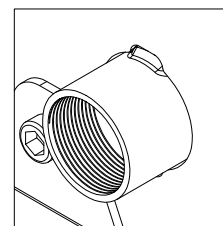

WARRANTY

A - Onda S.p.A. warrants that the Products shall be free from defects in material and workmanship for a period of 18 months from the date of the delivery.

Therefore, should Onda S.p.A., within the warranty period, acknowledge and recognise in writing the existence of the defects in the products and said defects be materially grounded, Onda S.p.A. shall, at its discretion, repair the defective Products at no costs for the Client or replace them by delivering the substitutive products Ex works (Incoterms 2000) at Onda S.p.A.'s premises (Via Lord Baden Powell, 11 – 36045 Lonigo (VI) – Italy).

B - Subject to loss of the warranty, notice of any defect shall be given by the Client in writing with return receipt registered letter within, and not later than, 10 (ten) days from the date of receipt of the products or from the start up of the plant. Subject to loss of the warranty, notice of any latent defect of the Products by the Client shall be given in writing, by return receipt registered letter, within and not later than 10 (ten) days from the date of the relevant discovery. It is hereby understood that the burden of the proof of the date of the discovery shall be borne by the Client.

C - Onda S.p.A. also warrants that the Products are manufactured in compliance with the Italian and European Laws and Regulations in force on the date of the confirmation by Onda S.p.A. of the relevant Client's order. Unless otherwise expressly agreed in writings by the parties, Client shall bear any other additional expenses related to the operations of repairing or replacing of the defective products.

D - This warranty shall not apply should the defects of the Products be caused by:

- Natural wear and tear.
- Unauthorised repairs, interventions or modifications.
- Unsuitable use or application.
- Thermal overexposure, also when occasional.
- Electrical or mechanical over-stress.
- Failure of respecting the functional and environmental parameters suggested by Onda S.p.A. for the correct use and exploitation of the products.

- Installation of the products not in compliance with the technical specifications provided by Onda S.p.A.
- Missing earth grounding.
- Any other cause due to the Client's negligence.

E - This warranty shall also not apply in case of:

- Non compliance of the Products with Italian and European Laws and/or Regulations entered in force after the date of transmission of the order confirmation by Onda S.p.A.
- Non compliance of the Products with Laws and/or Regulations in force in the place where the Products are installed and/or assembled by the Client and/or in the place of their final use, should the Client not expressly require the conformity of the Products to said Laws and Regulations and not duly inform Onda S.p.A. of their content before the date of transmission of the latter's order confirmation. This limitation of the warranty is also applicable with reference to peculiar Laws and Regulations valid and binding in States of the European Union independently of the European Laws and Regulations.

F - The Client shall not sell or market Products not in compliance with the Laws and Regulations mentioned under letter E above. In the negative, the Client shall keep ONDA S.p.A. harmless of any damage or loss suffered by the latter, due to any third party's and/or authority's claim raised as a consequence of the manufacture by ONDA S.p.A. of Products not in compliance with the above mentioned Laws and Regulations.

G - Without prejudice to the application of DPR 224/1988 on product liability and liability for gross negligence or wilful misconduct, Onda S.p.A. shall never be liable for direct, indirect or occasional damages which in any manner derived from defective products.



Onda USA L.L.C.
600 London Rd
Delaware, OH 43015
t. +1 614 321 3342
www.onda-us.com
onda@onda-us.com